

- NOTES:
- THIS DRAWING IS FOR GENERAL FIXTURING LAYOUT AND REFERENCE TO EQUIPMENT ONLY. ALL INFORMATION IS FOR ALDI OPERATIONAL USE ONLY AND SHALL NOT BE USED FOR CONSTRUCTION OR BIDDING PURPOSES.
 - ALL DIMENSIONS TO WALLS ARE TO FACE OF STUD UNLESS NOTED OTHERWISE.
 - THIS FACILITY DOES NOT CONTAIN A BAKERY, A BUTCHER, A DELI OR FISH COUNTER.
 - ALL FOOD IS PREPACKAGED, THERE IS NO ON SITE FOOD PREPARATION.
 - GONDOLA LOCATIONS ARE MEASURED FROM THE FACE OF THE STAINLESS STEEL PRICE TAG MOLDING (SSPTM).

REAR DOCK OPERATIONS DATA	
ITEM	V9.0 PROTOTYPE
LINEAR FOOTAGE OF BASE (PRODUCE INCLUDED)	828'-2"
ASSUMED PALLET STORAGE	50
BUILDING DIMENSIONS	104'-10" x 183'-2"
SALES FLOOR DIMENSIONS	75'-1" x 164'-0"
LENGTH OF MULTIDECK	120'
COOLER MILK DOORS	4
COOLER GENERAL DOORS	12
FREEZER GENERAL DOORS	16
SPOT MERCHANDISERS	10
CART STORAGE	84

REAR DOCK AREA SUMMARY		
OCCUPANCY USE	ROOM NAME	SQUARE FOOTAGE
STORAGE / STOCK (S-2)	BACKROOM	2,339
	COOLER	1,435
	FREEZER	674
	eCOMMERCE	286
SUBTOTAL (STORAGE / STOCK)		4,734
SUBTOTAL (OCCUPANCIES)		18,417
EXTERIOR / INTERIOR WALLS / UNOCCUPIED SPACE		1,214
BUILDING AREA		19,431
EXTERIOR CANOPY		644
TOTAL AREA (INCLUDING CANOPY)		20,275

REAR DOCK AREA SUMMARY		
OCCUPANCY USE	ROOM NAME	SQUARE FOOTAGE
MERCANTILE (M)	SALES / VESTIBULE	12,620
	UNISEX 2	79
	UNISEX 1	78
	HALL	132
SUBTOTAL (MERCANTILE)		12,909
BUSINESS (B)	OFFICE	259
	BREAK ROOM	297
	UTILITY ROOM	218
SUBTOTAL (BUSINESS)		774

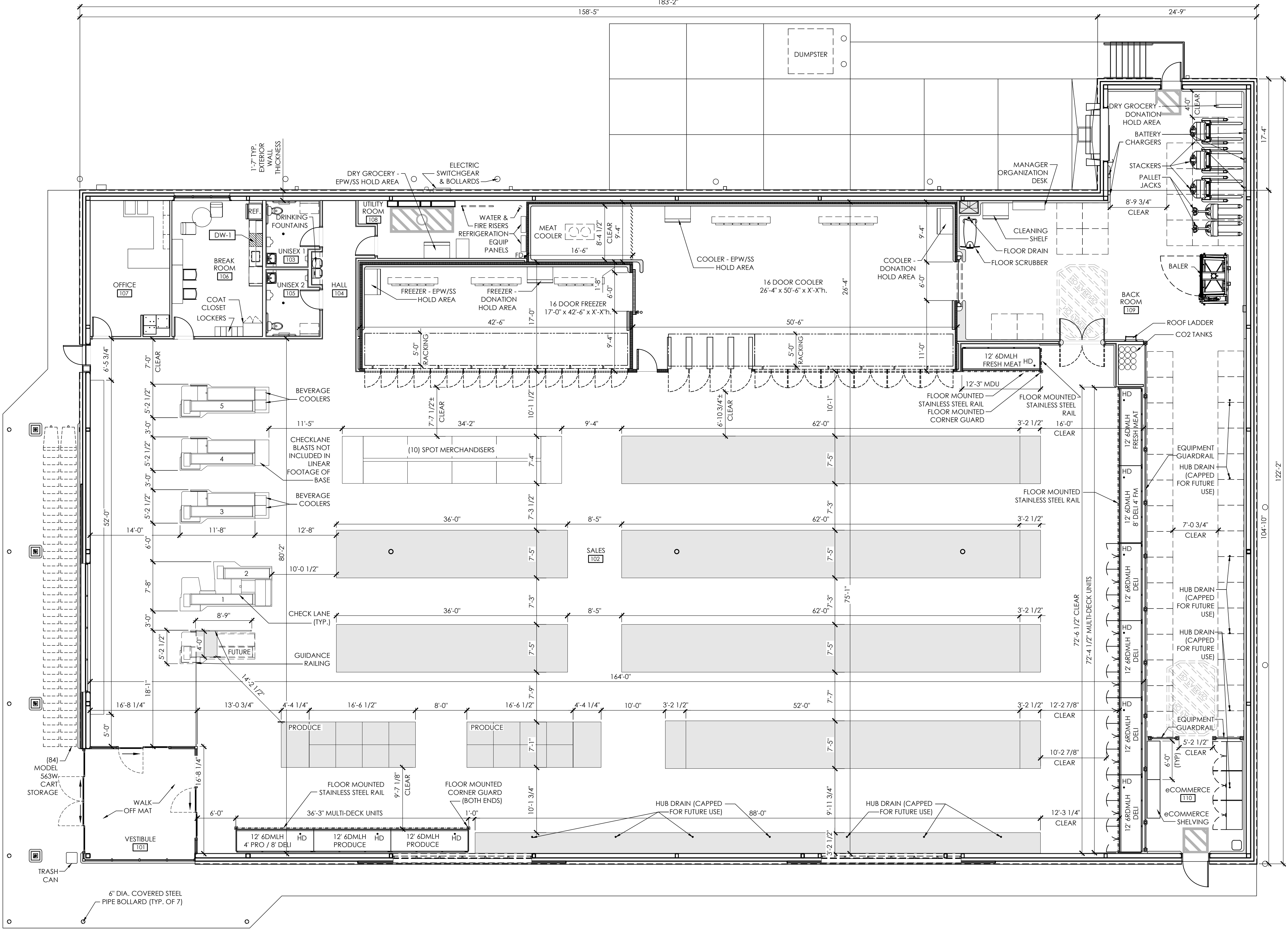

1 Operations Plan
SCALE: 1/8" = 1'-0"



Amanda Speranza-Kelly,
AIA, NCARB
615 Fishers Run Victor, NY 14564
585.742.2222 - www.apd.com

Copyright © 2025
Amanda Speranza-Kelly, AIA, NCARB
(610) 798-9200

Drawing Alteration

It is a violation of law for any person, unless acting under the direction of licensed Architect, Professional Engineer, Landscape Architect, or Land Surveyor to alter any item on this document in any way. Any licensee who alters this document is required by law to affix his or her seal and to add the notation "Altered By" followed by his or her signature and the specific description of the alteration or revision.

DO NOT SCALE PLANS

Copying, Printing, Software and other processes required to produce these prints can stretch or shrink the actual paper or layout. Therefore, scaling of this drawing may be inaccurate. Contact Architect with any need for additional dimensions or clarifications.

Issued:	Date:
A	
B	
C	
D	
E	

Revisions:	Date:
1	
2	
3	
4	
5	
6	
7	
8	
9	
10	
11	
12	

PROJECT ARCHITECT/ENGINEER

PROJECT LEAD

NOT FOR
CONSTRUCTION

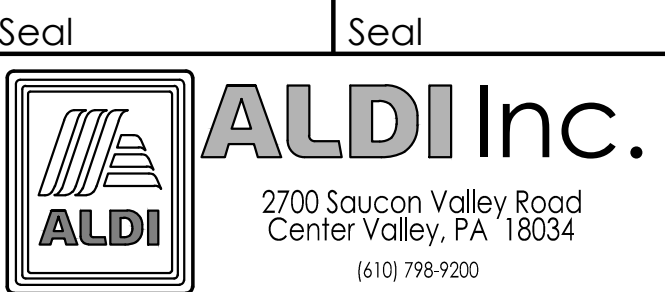

ALDI Inc. Store #: XX
Barnegat NJ
10 Barnegat Boulevard
Barnegat NJ, 08005
Ocean City County
Project Name & Location:

Operations Plan

Drawing Name:	Prototype:	Project No.
	V9.0	24-0464
Type:	GROUND UP	
Drawn By:	ARC	A-131
Scale:	As Noted	Drawing No.