

KEY MAP 2

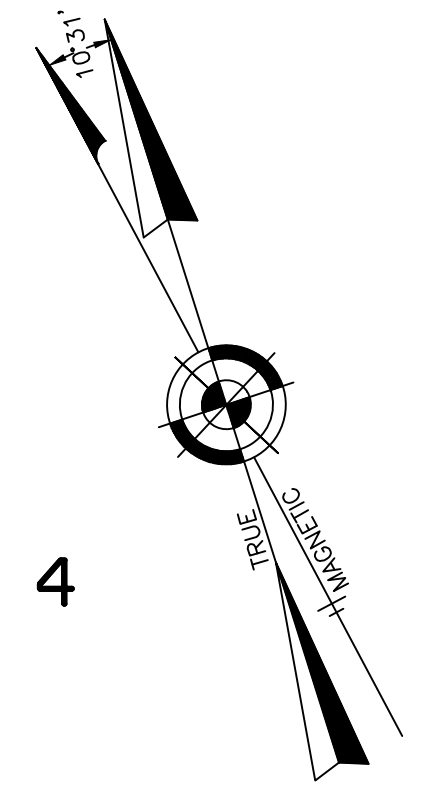

SEE KEY MAP 4

KEY MAP

10	PLATE NUMBER
107	BLOCK NUMBER
---	LOT-LINE
---	ARTIFICIAL-BLOCK-LIMIT-LINE
(MATCH LINE)	MATCH LINE
---	PLATE DELINEATION LINE
---	KEY MAP DELINEATION LINE
---	MUNICIPAL BOUNDARY LINE
---	COUNTY BOUNDARY LINE
---	WATERWAY LINES
---	ASSESSMENT LINE
---	TIDELANDS LINE
W.L.A.	WETLAND AREA - W.L.A.
F.H.A.	FLOOD HAZARD AREA - F.H.A.
---	PIERHEAD OR BULKHEAD LINE
---	PIERHEAD OR BULKHEAD LINE (BLOCK LIMIT LINE)

KEY MAP 2 TOWNSHIP OF BARNEGAT

OCEAN COUNTY NEW JERSEY
SCALE: 1" = 500' DATE: 11-14-2003

CRAIG F. REMINGTON LAND SURVEYOR LIC. NO. 23924



REMINGTON, VERNICK & VENA ENGINEERS
24 GA 28003300
9 ALLEN STREET, TOMS RIVER, N.J. 08753
(732) 286-9220, FAX (732) 505-9416
WEB SITE ADDRESS: WWW.RVVE.COM

TO SHOW CONDITIONS AS OF 11-23-2021

KEY MAP 2

REVISIONS		
DATE	NAME	NO.
6-23-2015	CHARLES E. ADAMSON	42627
5-30-2017	CHARLES E. ADAMSON	42627
11-28-2017	CHARLES E. ADAMSON	42627
12-28-2018	CHARLES E. ADAMSON	42627
9-16-2020	CHARLES E. ADAMSON	42627
11-16-2021	CHARLES E. ADAMSON	42627

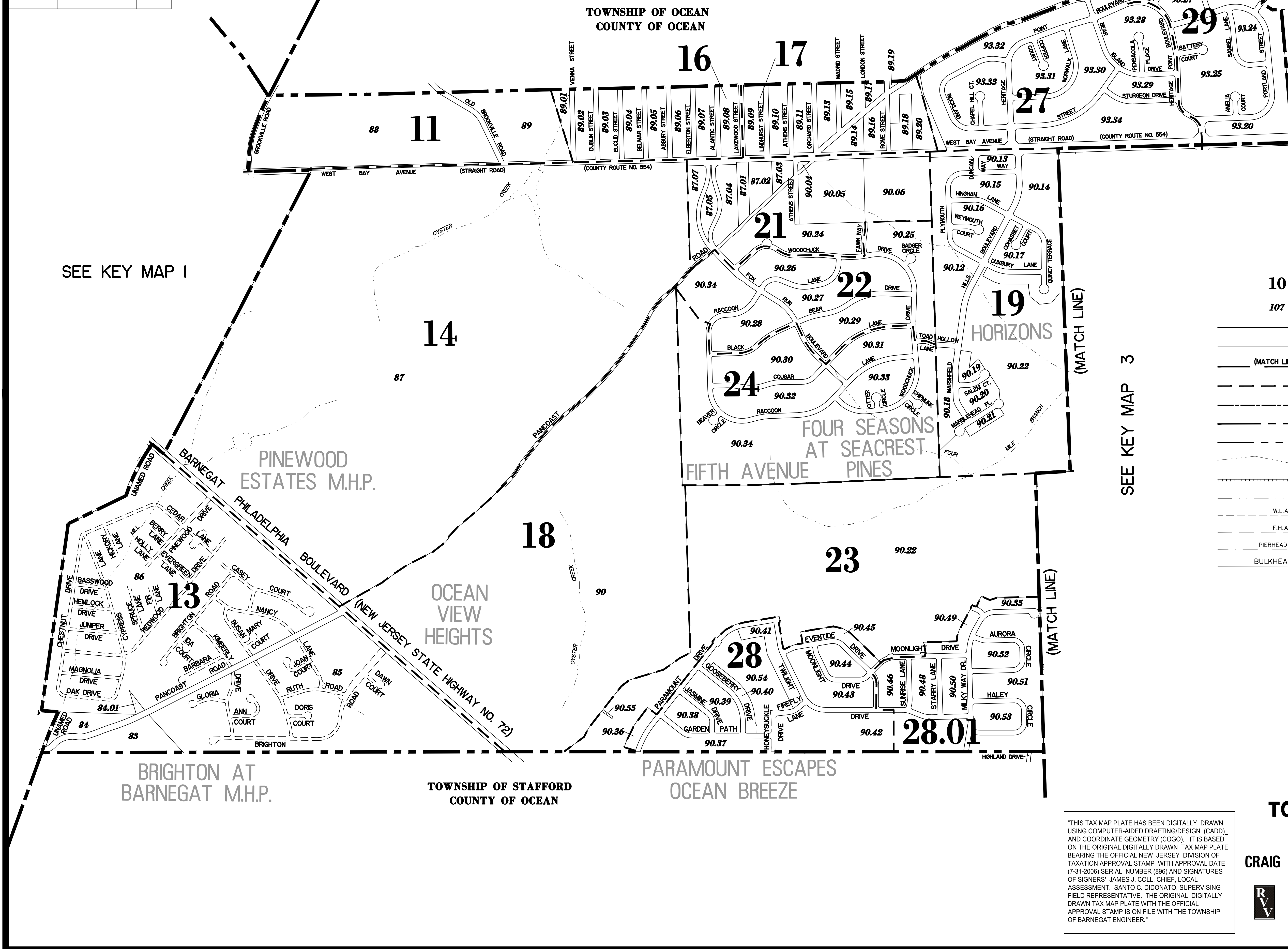

"THIS TAX MAP PLATE HAS BEEN DIGITALLY DRAWN USING COMPUTER-AIDED DRAFTING/DESIGN (CADD) AND COORDINATE GEOMETRY (COGO). IT IS BASED ON THE ORIGINAL DIGITALLY DRAWN TAX MAP PLATE BEARING THE OFFICIAL NEW JERSEY DIVISION OF TAXATION APPROVAL STAMP WITH APPROVAL DATE (7-31-2006) SERIAL NUMBER (896) AND SIGNATURES OF SIGNERS: JAMES J. COLL, CHIEF, LOCAL ASSESSMENT; SANTO C. DIDONATO, SUPERVISING FIELD REPRESENTATIVE. THE ORIGINAL DIGITALLY DRAWN TAX MAP PLATE WITH THE OFFICIAL APPROVAL STAMP IS ON FILE WITH THE TOWNSHIP OF BARNEGAT ENGINEER."

SEE KEY MAP 1

SEE KEY MAP 3