

PLAN
SCALE: 1"=50'

BLOCK 202, LOT 11
MORNING HARBOR CONDOMINIUM
7701 ATLANTIC AVENUE
INSET "H"

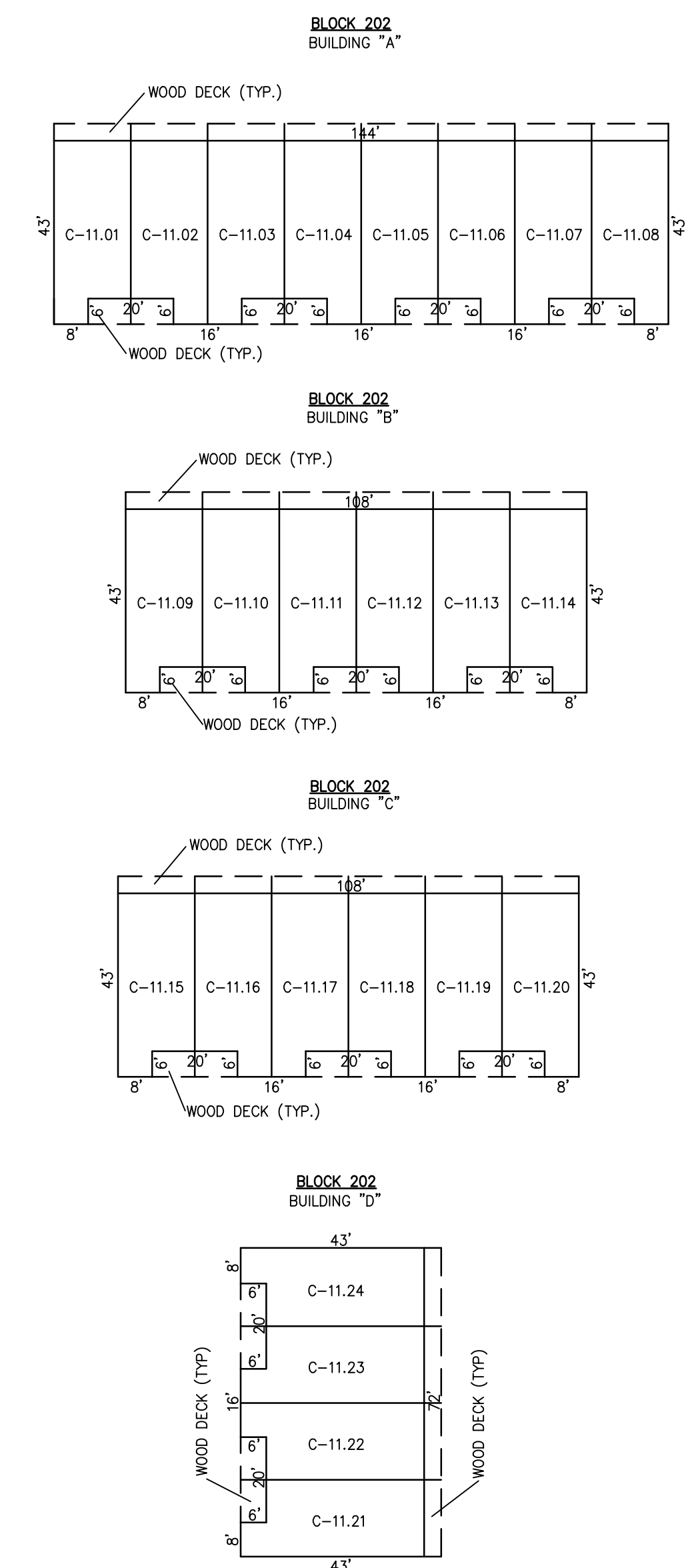

DETAILS
SCALE: 1"=30'

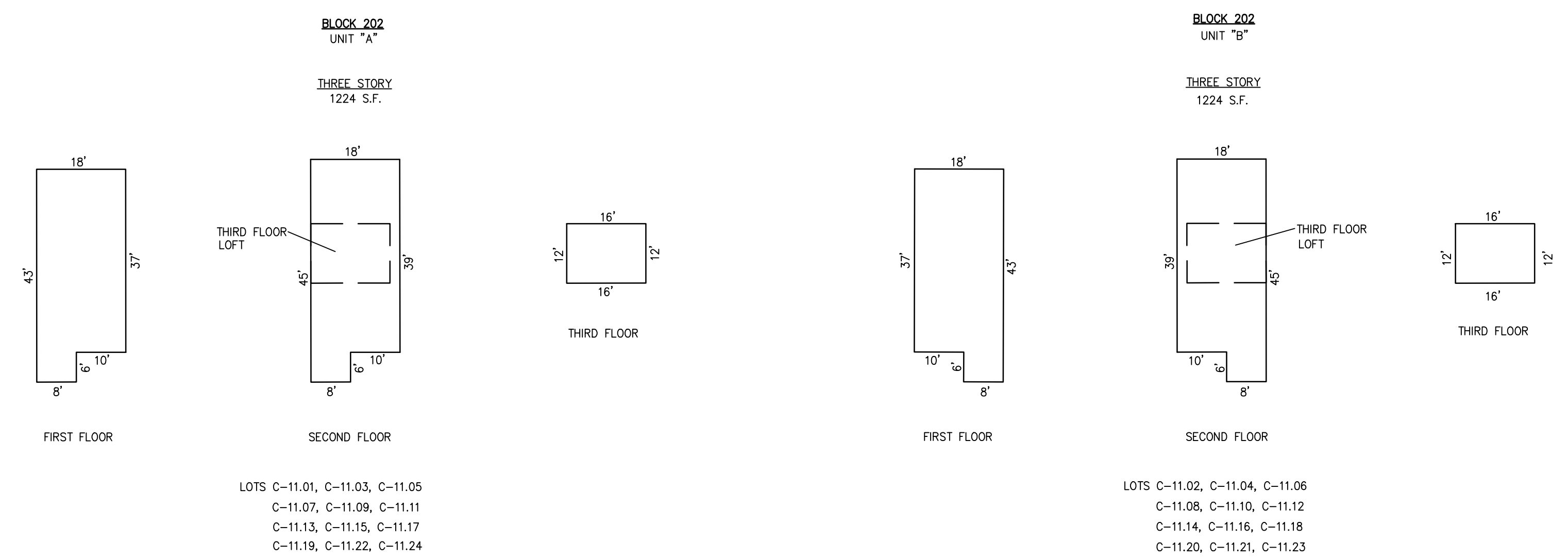

LOTS C-11.01, C-11.03, C-11.05
C-11.07, C-11.09, C-11.11
C-11.13, C-11.15, C-11.17
C-11.19, C-11.22, C-11.24

LOTS C-11.02, C-11.04, C-11.06
C-11.08, C-11.10, C-11.12
C-11.14, C-11.16, C-11.18
C-11.20, C-11.21, C-11.23

NOTE: DIMENSIONS AND SQUARE FOOTAGE ARE TYPICAL FOR SIMILAR UNITS

DETAILS
SCALE: 1"=20'

CONDOMINIUM DETAILS AND DIMENSIONS
BLOCK 202, LOT 11
SEE PLATE I27

TAX MAP
TOWNSHIP OF BARNEGAT

OCEAN COUNTY NEW JERSEY
SCALE: NOTED DATE: 5-11-2005

CRAIG F. REMINGTON LAND SURVEYOR LIC. NO. 23924

REMINGTON, VERNICK & VENA ENGINEERS
24 GA 28003300
9 ALLEN STREET, TOMS RIVER, NJ 08753
(732) 296-9220, FAX (732) 505-8416
WEB SITE ADDRESS: WWW.RVE.COM

TO SHOW CONDITIONS AS OF 11-23-2021

REVISIONS		
5-20-2007	CRAIG F. REMINGTON	23924

"THIS TAX MAP PLATE HAS BEEN DIGITALLY DRAWN USING COMPUTER-AIDED DRAFTING/DESIGN (CADD) AND COORDINATE GEOMETRY (COGO). IT IS BASED ON THE ORIGINAL DIGITALLY DRAWN TAX MAP PLATE BEARING THE OFFICIAL NEW JERSEY DIVISION OF TAXATION APPROVAL STAMP WITH APPROVAL DATE (7-31-2006) SERIAL NUMBER (896) AND SIGNATURES OF SIGNERS' JAMES J. COLL, CHIEF, LOCAL ASSESSMENT. SANTO C. DIDONATO, SUPERVISING FIELD REPRESENTATIVE. THE ORIGINAL DIGITALLY DRAWN TAX MAP PLATE WITH THE OFFICIAL APPROVAL STAMP IS ON FILE WITH THE TOWNSHIP OF BARNEGAT ENGINEER."