

LIST OF UTILITIES	
COMCAST	830 ROUTE 37 WEST TOMS RIVER, NJ 08755 732-286-2971
CONNECTIV (FORMERLY ATLANTIC ELECTRIC)	REAL ESTATE DEPARTMENT 457 US HWY 9 WEST CREEK, NJ 08092 609-296-9114
BARNEGAT WATER & SEWER UTILITY	500 WEST BAY AVE BARNEGAT, NJ 08005 609-698-0080
SOUTH JERSEY GAS	1 SOUTH JERSEY PLAZA FOLSOM, NJ 08037
GPU ENERGY (FORMERLY JCP&L CO)	P.O. BOX 16001 REAL ESTATE DEPT READING, PA 19640-0001 610-921-6201
VERIZON	54 BROAD ST. ROOM 305 NEWARK, NJ 07101
NJ NATURAL GAS CO	1415 WYCKOFF ROAD P.O. BOX 1464 WALL, NJ 07719 732-938-1096
OCEAN COUNTY UTILITY AUTHORITY	501 HICKORY LANE, P.O. BOX P BAYVILLE, NJ 08721 732-269-4500
TOWNSHIP OF OCEAN DEPT OF UTILITIES	50 RAILROAD AVE WARETOWN, NJ 08758 609-693-3668

OWNER & ADDRESS REPORT – LOTS 15 & 16 IN BLOCK 92.09 – BARNEGAT TOWNSHIP CERTIFIED 200 FOOT LIST									
BLOCK	LOT	PROPERTY OWNER	PROPERTY LOCATION	BLOCK	LOT	PROPERTY OWNER	PROPERTY LOCATION	BLOCK	LOT
92.05	1	WALTERS DEVELOPMENT CO LLC 500 BARNEGAT BLVD N #100 BARNEGAT, NJ 08005	235 BARRACUDA ROAD	92.06	11	WALTERS DEVELOPMENT CO LLC 500 BARNEGAT BLVD N #100 BARNEGAT, NJ 08005	536 MERMAID DRIVE	92.10	1
92.05	32	WALTERS DEVELOPMENT CO LLC 500 BARNEGAT BLVD N #100 BARNEGAT, NJ 08005	546 MERMAID DRIVE	92.09	12	WALTERS DEVELOPMENT CO LLC 500 BARNEGAT BLVD N #100 BARNEGAT, NJ 08005	537 MERMAID DRIVE	92.10	2
92.05	33	MAJCHER, JOHN 62 YONES LANE RAITON, NJ 08869	554 MERMAID DRIVE	92.09	13	WALTERS DEVELOPMENT CO LLC 500 BARNEGAT BLVD N #100 BARNEGAT, NJ 08005	539 MERMAID DRIVE	92.10	3
92.06	5	WALTERS DEVELOPMENT CO LLC 500 BARNEGAT BLVD N #100 BARNEGAT, NJ 08005	229 BARRACUDA ROAD	92.09	14	WALTERS DEVELOPMENT CO LLC 500 BARNEGAT BLVD N #100 BARNEGAT, NJ 08005	541 MERMAID DRIVE	92.10	4
92.06	6	WALTERS DEVELOPMENT CO LLC 500 BARNEGAT BLVD N #100 BARNEGAT, NJ 08005	231 BARRACUDA ROAD	92.09	17	WALTERS DEVELOPMENT CO LLC 500 BARNEGAT BLVD N #100 BARNEGAT, NJ 08005	123 WINDJAMMER DRIVE	92.10	26
92.06	7	WALTERS DEVELOPMENT CO LLC 500 BARNEGAT BLVD N #100 BARNEGAT, NJ 08005	233 BARRACUDA ROAD	92.09	18	WALTERS DEVELOPMENT CO LLC 500 BARNEGAT BLVD N #100 BARNEGAT, NJ 08005	31 WRIGHT ROAD	92.10	27
92.06	8	WALTERS DEVELOPMENT CO LLC 500 BARNEGAT BLVD N #100 BARNEGAT, NJ 08005	542 MERMAID DRIVE	92.09	19	WALTERS DEVELOPMENT CO LLC 500 BARNEGAT BLVD N #100 BARNEGAT, NJ 08005	27 WRIGHT ROAD	92.10	28
92.06	9	WALTERS DEVELOPMENT CO LLC 500 BARNEGAT BLVD N #100 BARNEGAT, NJ 08005	540 MERMAID DRIVE	92.09	20	WALTERS DEVELOPMENT CO LLC 500 BARNEGAT BLVD N #100 BARNEGAT, NJ 08005	25 WRIGHT ROAD	92.10	29
92.06	10	WALTERS DEVELOPMENT CO LLC 500 BARNEGAT BLVD N #100 BARNEGAT, NJ 08005	538 MERMAID DRIVE	92.10	1	NARDI, THOMAS F & WENDY C 842 BERKELEY AVE TRENTON, NJ 08610	29 JOLLY ROGER DRIVE	92.10	30

ZONING SCHEDULE			
ZONING DISTRICT:	"RH" DISTRICT		
CATEGORY	REQUIRED	LOT 15	LOT 16
MINIMUM LOT AREA	10,000 SQ. FT.	12,926 SQ. FT.	10,008 SQ. FT.
MINIMUM LOT WIDTH	75 FT.	120.71 FT.	82.91 FT.
MINIMUM LOT FRONTAGE	2/3 OF LOT WIDTH	218.18 FT.	120.71 FT.
MINIMUM LOT DEPTH	120 FT.	120.71 FT./108.20 FT.*	120.71 FT.
PRINCIPAL BUILDING			
MINIMUM FRONT YARD	30 FT.	30 FT.	30 FT.
MINIMUM REAR YARD	30 FT.	30 FT.	30 FT.
MINIMUM SIDE YARD	10 FT.	10 FT.	10 FT.
MINIMUM SIDE YARD (TOTAL)	20 FT.	20 FT.	20 FT.
ACCESSORY BUILDING			
MINIMUM REAR YARD	5 FT.	5 FT.	5 FT.
MINIMUM SIDE YARD	5 FT.	5 FT.	5 FT.
MAXIMUM BUILDING HEIGHT	35 FEET/2.5 STORIES	35 FEET/2.5 STORIES	35 FEET/2.5 STORIES
MAXIMUM BUILDING COVER	30 %	30 %	30 %
* VARIANCE REQUIRED			

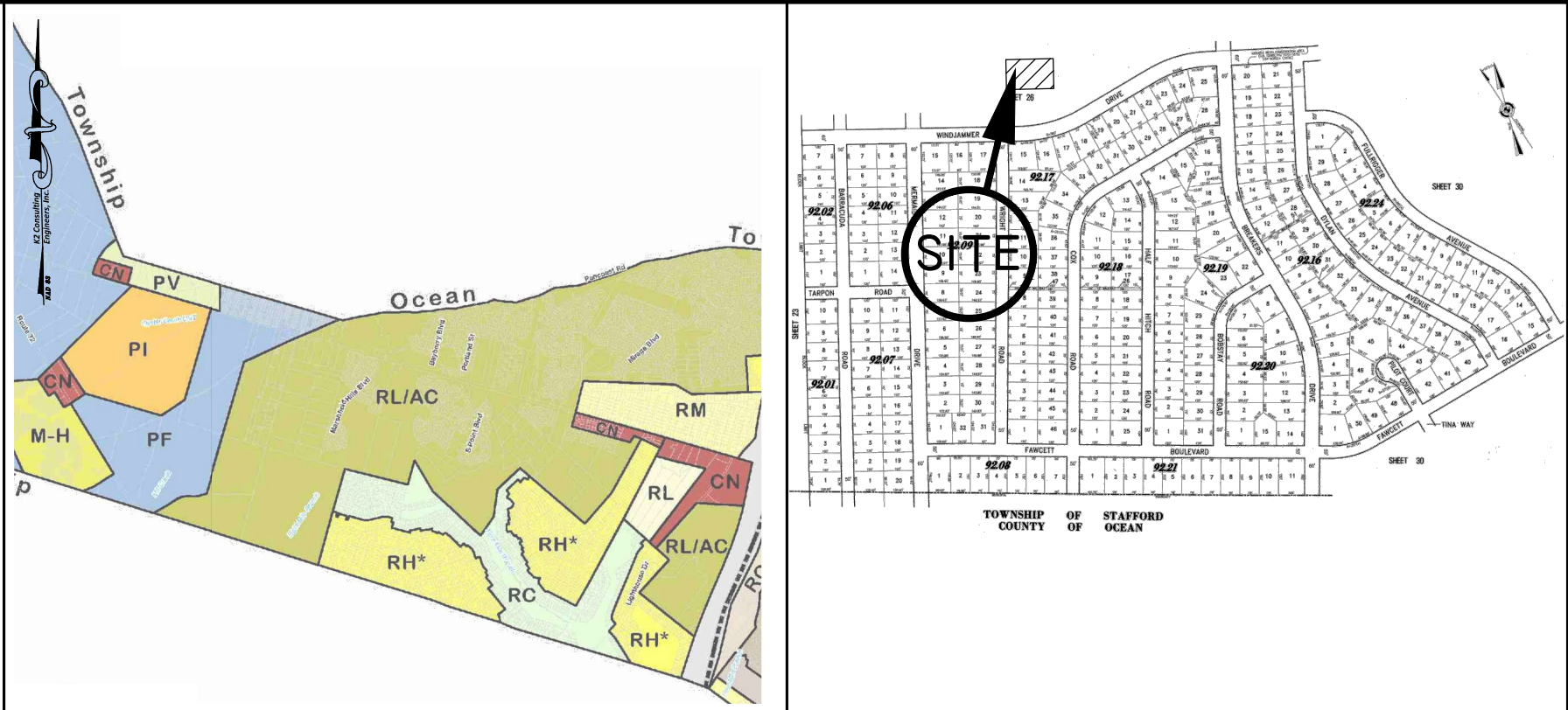

- NOTES
- OWNER/APPLICANT: THE WALTERS GROUP
21 E. EUCLID AVENUE, SUITE 200
HADDONFIELD, NJ 08033
 - THIS PLAN HAS BEEN PREPARED WITHOUT THE BENEFIT OF A TITLE REPORT. SHOULD ADDITIONAL TITLE/BOUNDARY INFORMATION BECOME AVAILABLE, K2 CONSULTING ENGINEERS, INC. RESERVES THE RIGHT TO AMEND AND/OR REVISE THIS PLAN.
 - BASE INFORMATION TAKEN FROM A PLAN OF LOTS, OCEAN ACRES, SECTION NO. 26, UNION TOWNSHIP, OCEAN COUNTY, NEW JERSEY, DATED MAY 5, 1972, DULY FILED
 - BEING KNOWN AS LOT 15 AND LOT 16 IN BLOCK 92.09 ON TAX MAP SHEET 25 AS SHOWN ON THE OFFICIAL TAX MAP OF THE TOWNSHIP OF BARNEGAT, OCEAN COUNTY, NEW JERSEY
 - WE ARE NOT EXPERTS IN THE DETECTION AND/OR IDENTIFICATION OF POTENTIALLY HAZARDOUS SOILS AND SUBSTANCES; THEREFORE, THIS PLAN DOES NOT PURPORT TO LOCATE OR REVEAL SAME.
 - FRESHWATER WETLANDS, IF ANY, ARE NOT LOCATED BY THIS PLAN.
 - THIS PLAN IS NOT INTENDED TO GUARANTEE OWNERSHIP.
 - EXCEPT AS STATED OR SHOWN ON THIS PLAN, THIS SURVEY DOES NOT PURPORT TO REFLECT ANY OF THE FOLLOWING WHICH MAY BE APPLICABLE TO THE SUBJECT REAL ESTATE: EASEMENTS, OTHER THAN THOSE EVIDENT AT THE TIME OF MAKING OF THIS SURVEY; RESTRICTIVE COVENANTS; SUBDIVISION RESTRICTIONS; ZONING OR OTHER LAND USE REGULATIONS; AND ANY OTHER FACTS WHICH AN ACCURATE AND CURRENT TITLE SEARCH MAY DISCLOSE.
 - PROPERTIES ARE TO BE SERVICED BY MUNICIPAL WATER AND SEWER.
 - HORIZONTAL INFORMATION BASED ON AN ASSUMED DATUM.
 - VERTICAL INFORMATION BASED ON NORTH AMERICAN VERTICAL DATUM OF 1988 (NAVD 88).
 - EXISTING LOT LINES WITHIN THE SUBDIVISION ARE TO BE ELIMINATED WITH THE FILING OF THIS PLAN.

LOT AREA TABLE		
LOT	EXISTING LOT AREA	PROPOSED LOT AREA
15	13,412 SF 0.308 ACRES	12,926 SF 0.296 ACRES
16	9,657 SF 0.222 ACRES	10,008 SF 0.230 ACRES

CURVE TABLE				
Curve #	Length	Radius	Chord Direction	Chord Length
C1	39.27'	25.00'	N60° 54' 50"E	35.36'

IT IS HEREBY CERTIFIED THAT THE LANDS SUBDIVIDED BY THIS MAP ARE OWNED BY TITLE OF RECORD AND THAT CONSENT TO THE APPROVAL OF SAID MAP IS GIVEN.

LOT 15 & 16 – WALTERS DEVELOPMENT CO LLC
500 BARNEGAT BLVD N #100
BARNEGAT, NJ 08005

SWORN TO AND SUBSCRIBED BEFORE ME.

NOTARY _____ DATE _____

APPROVED AS A MINOR SUBDIVISION BY THE BARNEGAT TOWNSHIP PLANNING BOARD.

CHAIRMAN _____ DATE _____

SECRETARY _____ DATE _____

TOWNSHIP ENGINEER _____ DATE _____

I CERTIFY THAT THIS MAP COMPLIES WITH THE PROVISIONS OF THE "MAP FILING LAW" P.L. 2011, CHAPTER 217, AND FURTHER CERTIFY THAT IT HAS BEEN APPROVED FOR FILING IN THE OFFICE OF THE COUNTY CLERK OF OCEAN COUNTY BY THE PLANNING BOARD OF BARNEGAT TOWNSHIP.

THIS CERTIFICATION SHALL EXPIRE IF THIS MAP IS NOT PROPERLY FILED WITH SAID COUNTY CLERK ON OR BEFORE _____ DAY OF _____

SECRETARY _____ DATE _____

I HAVE CAREFULLY EXAMINED THIS MAP AND TO THE BEST OF MY KNOWLEDGE AND BELIEF FIND IT CONFORMS WITH THE PROVISIONS OF THE "MAP FILING LAW", RESOLUTION OF APPROVAL AND THE MUNICIPAL ORDINANCES AND REQUIREMENTS APPLICABLE THERETO.

TOWNSHIP ENGINEER _____ DATE _____

LEGEND	
	EXISTING PROPERTY BOUNDARY
	EXISTING ADJACENT LOT LINE
	PROPOSED LOT LINE
	SETBACK LINE
15	LOT NUMBER PER TAX MAP
92.09	BLOCK NUMBER PER TAX MAP
○	CORNER TO BE SET



REVISIONS		DATE:	12/09/2019
		DRAWN BY:	TLM
		CHECKED BY:	JRG
		SCALE:	1"=30'
		JOB NO.:	PD19-050
		SHEET	1 OF 1

I HEREBY CERTIFY TO THE BEST OF MY KNOWLEDGE AND BELIEF THIS MAP AND LAND SURVEY DATED DECEMBER 9, 2019 MEETS THE MINIMUM SURVEY DETAIL REQUIREMENTS, WITH THE OUTBOUND CORNERS MARKED, AS PROMULGATED BY THE STATE BOARD OF PROFESSIONAL ENGINEERS AND LAND SURVEYORS AND HAS BEEN MADE UNDER MY SUPERVISION, AND COMPLIES WITH THE PROVISIONS OF THE "MAP FILING LAW" AND THAT THE OUTBOUND CORNER MARKERS, AS SHOWN, HAVE BEEN FOUND OR SET.

Jeffrey R. Gelenthin
JEFFREY R. GELLENTHIN, P.L.S.
Professional Land Surveyor, NJ License No. GS-36730

K2
Consulting Engineers, Inc.
Professional Civil Engineers
& Land Surveyors
Certificate of Authorization
#K000000000
36 Tanner Street, Suite 100
Haddonfield, New Jersey 08033
Phone - 856.310.5202
Fax - 856.616.2441
www.K2CE.com

MINOR SUBDIVISION PLAN
OF
WALTERS HOMES
LOT 15 AND LOT 16 IN BLOCK 92.09
ON TAX MAP SHEET 25
SITUATE IN THE
TOWNSHIP OF BARNEGAT
OCEAN COUNTY, NEW JERSEY