

- NOTES:**
1. PRIOR TO PAVEMENT INSTALL WITHIN CENTER ISLAND, CONTRACTOR TO PROVIDE OWNER WITH APPROPRIATE CUT SHEETS ON CURBS & PAVEMENT INSTALL & MEET IN FIELD W/ OWNERS REPRESENTATIVE TO REVIEW PAVEMENT PITCH & DRAINAGE. CONTRACTOR IS FULLY RESPONSIBLE TO ENSURE ADEQUATE DRAINAGE OF PAVEMENT AREA.
 2. FINAL PAVEMENT PATTERN PER DETAIL SHEET.
 3. ALL ADA PARKING SPACES SHALL MEET APPLICABLE ADA MAXIMUM SLOPE REQUIREMENTS.
 4. OWNER SHALL SELECT FINAL PAVEMENT COLORS.

OMICK, INC. MECHANICAL & ELECTRICAL ENGINEERS
 1000 UNIVERSITY AVENUE, SUITE 200, BARNEGAT, NJ 08005
 T: (609) 798-1800 F: (609) 798-1802

ALAN ALON, PE, STRUCTURAL ENGINEER
 1000 UNIVERSITY AVENUE, SUITE 200, BARNEGAT, NJ 08005
 T: (609) 798-1800 F: (609) 798-1802

ONE ASSOCIATES, CONSULTING AND MUNICIPAL ENGINEERS
 809 DEPT. 752, 410-2500 PARK ROAD, 7600
 LYONS CORPUS CENTER, BARNEGAT, NJ 08005
 T: (609) 798-1800 F: (609) 798-1802

GREGORY R. VALES, PE, PP
 N.J. LICENSE #4450344800

THE GOLDSTEIN PARTNERSHIP
 ARCHITECTS
 515 VALLEY STREET, SUITE 110, MAPLEWOOD, NJ 07040
 OFFICE: 973-761-4550
 COPYRIGHT © 2019 BY THE GOLDSTEIN PARTNERSHIP. ALL RIGHTS RESERVED.

BARNEGAT MUNICIPAL BUILDING
 900 WEST BAY AVENUE
 BARNEGAT, NJ 08005

GRADING AND DRAINAGE PLAN
 (2 OF 2)
 SCALE: AS NOTED
 DATE: 05/01/20
 DWN: DMG
 CND: KJO

THIS DRAWING IS INCOMPLETE UNLESS USED WITH ALL OTHER CONTRACT DOCUMENTS.

DRAWING NUMBER
C-10
 SHEET 86 OF 97

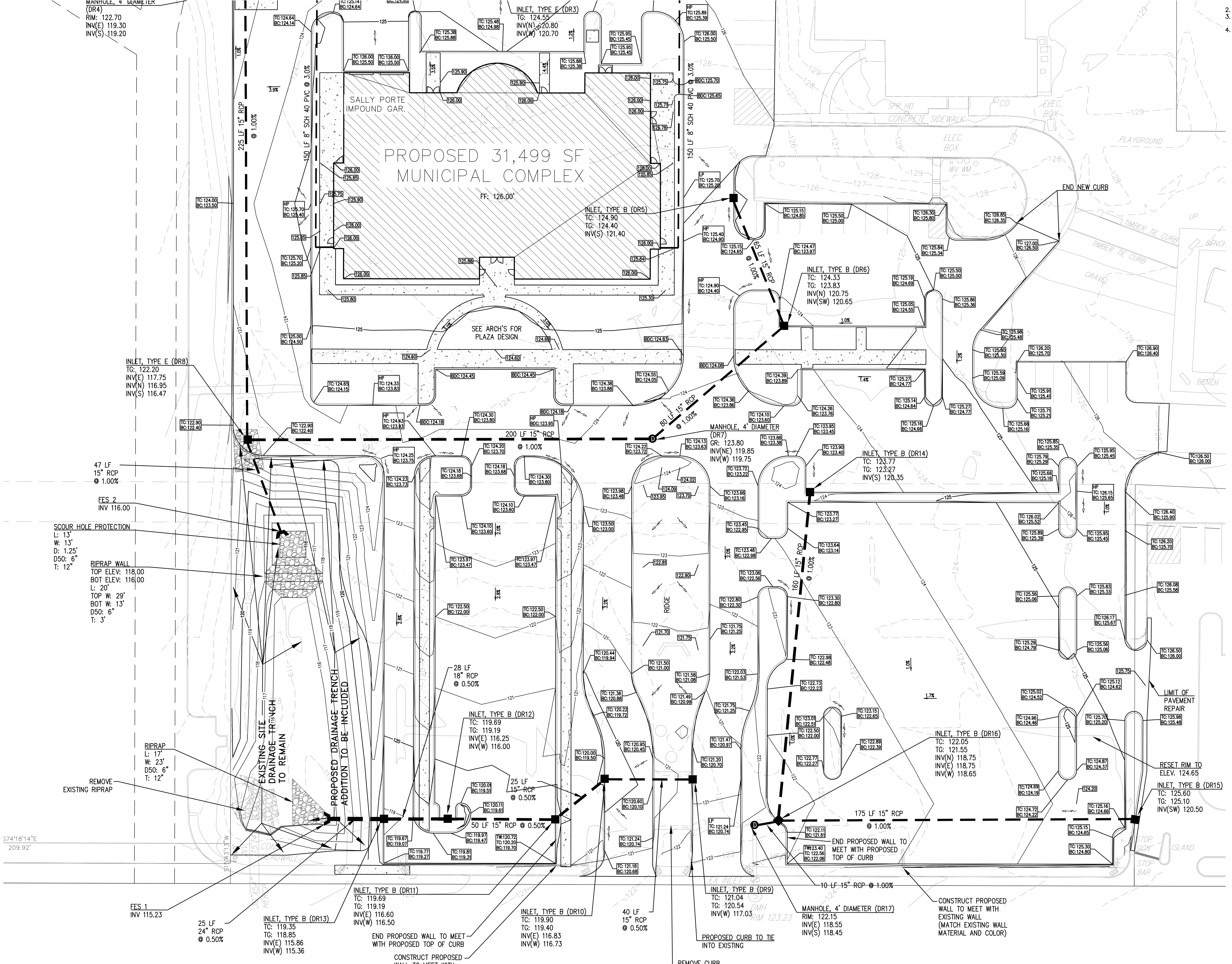

MANHOLE, 4' DIAMETER (DR4)
 RIM: 122.70
 INV(E): 119.30
 INV(S): 119.20

INLET, TYPE E (DR8)
 TC: 122.20
 INV(E): 117.75
 INV(N): 116.95
 INV(S): 116.47

47 LF 15" RCP @ 1.00%

SCOUR HOLE PROTECTION
 L: 13'
 W: 13'
 D: 1.25'
 D50: 6"
 T: 12"

RIPRAP WALL
 TOP ELEV: 118.00
 BOT ELEV: 116.00
 L: 20'
 TOP W: 29'
 BOT W: 13'
 D50: 6"
 T: 3"

RIPRAP
 L: 17'
 W: 23'
 D50: 6"
 T: 12"

FES 1
 INV 115.23

25 LF 24" RCP @ 0.50%

INLET, TYPE B (DR13)
 TC: 119.35
 TG: 118.85
 INV(E): 115.86
 INV(W): 115.36

END PROPOSED WALL TO MEET WITH PROPOSED TOP OF CURB
 CONSTRUCT PROPOSED WALL TO MEET WITH EXISTING WALL (MATCH EXISTING WALL MATERIAL AND COLOR)

INLET, TYPE B (DR10)
 TC: 119.90
 TG: 119.40
 INV(E): 116.83
 INV(W): 116.73

40 LF 15" RCP @ 0.50%

INLET, TYPE B (DR9)
 TC: 121.04
 TG: 120.54
 INV(W): 117.03

PROPOSED CURB TO TIE INTO EXISTING
 REMOVE CURB RETAINING WALL TO REMAIN

MANHOLE, 4' DIAMETER (DR17)
 RIM: 122.15
 INV(E): 118.55
 INV(S): 118.45

END PROPOSED WALL TO MEET WITH PROPOSED TOP OF CURB

175 LF 15" RCP @ 1.00%

CONSTRUCT PROPOSED WALL TO MEET WITH EXISTING WALL (MATCH EXISTING WALL MATERIAL AND COLOR)

INLET, TYPE B (DR15)
 TC: 125.60
 TG: 125.10
 INV(SW): 120.50

RESET RIM TO ELEV. 124.65

LIMIT OF PAVEMENT REPAIR

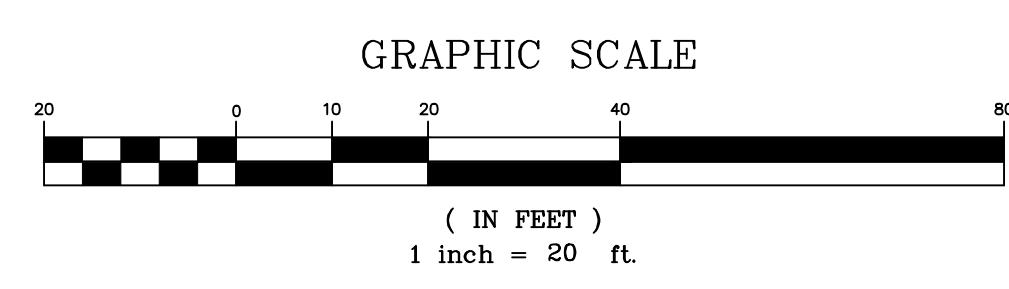

"KNOW WHAT'S BELOW"

CALL BEFORE YOU DIG
 NEW JERSEY ONE CALL
 DIAL 811 OR 800-272-1000
 "IT IS THE LAW"