

KEY MAP 3

REVISIONS		
DATE	NAME	NO.
12-10-2010	CRAIG F. REMINGTON	23924
12-5-2016	CHARLES E. ADAMSON	42627
5-30-2017	CHARLES E. ADAMSON	42627
11-19-2019	CHARLES E. ADAMSON	42627
11-16-2021	CHARLES E. ADAMSON	42627

SEE KEY MAP 4

SEE KEY MAP 6

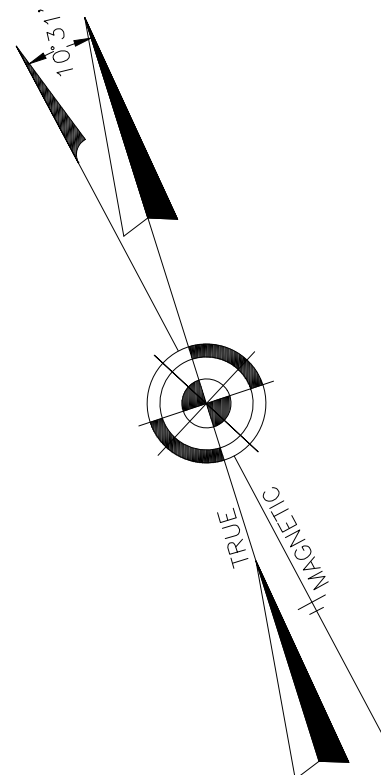

SEE KEY MAP 2

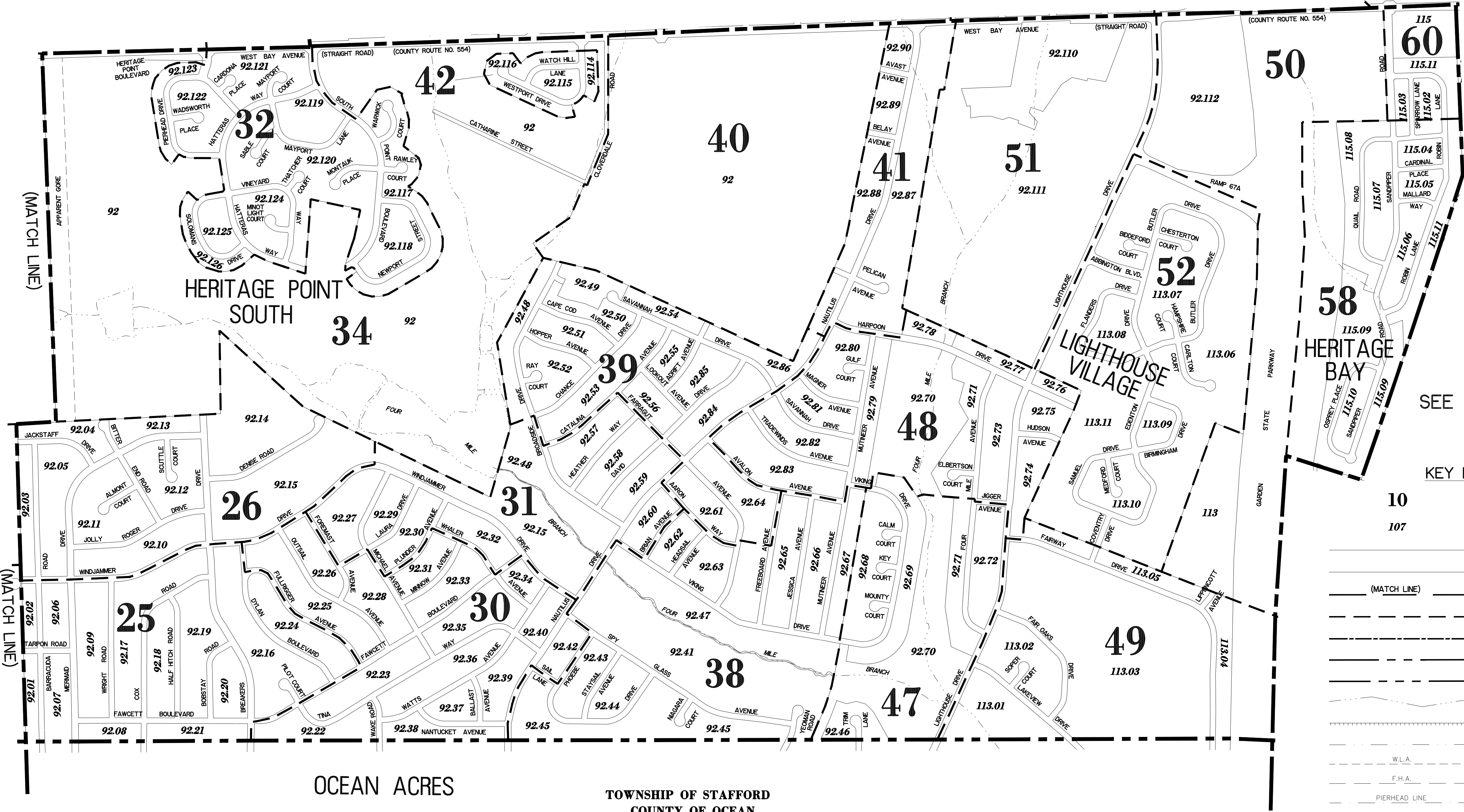

SEE KEY MAP 5

KEY MAP

- 107 PLATE NUMBER
- 107 BLOCK NUMBER
- (MATCH LINE) LOT-LINE
- (MATCH LINE) ARTIFICIAL-BLOCK-LIMIT-LINE
- (MATCH LINE) MATCH LINE
- (MATCH LINE) PLATE DELINEATION LINE
- (MATCH LINE) KEY MAP DELINEATION LINE
- (MATCH LINE) MUNICIPAL BOUNDARY LINE
- (MATCH LINE) COUNTY BOUNDARY LINE
- (MATCH LINE) WATERWAY LINES
- (MATCH LINE) ASSESSMENT LINE
- (MATCH LINE) TIDE LANDS LINE
- (MATCH LINE) W.L.A. WETLAND AREA - W.L.A.
- (MATCH LINE) F.H.A. FLOOD HAZARD AREA - F.H.A.
- (MATCH LINE) PIERHEAD LINE PIERHEAD OR BULKHEAD LINE
- (MATCH LINE) BULKHEAD LINE PIERHEAD OR BULKHEAD LINE (BLOCK LIMIT LINE)

KEY MAP 3
TOWNSHIP OF BARNEGAT

OCEAN COUNTY NEW JERSEY
SCALE: 1" = 500' DATE: 11-14-2003

CRAIG F. REMINGTON LAND SURVEYOR LIC. NO. 23924



REMINGTON, VERNICK & VENA ENGINEERS
9 ALLEN STREET, TOMS RIVER, N.J. 08753
(732) 286-9220, FAX (732) 505-8416
WEB SITE ADDRESS: WWW.RVE.COM

TO SHOW CONDITIONS AS OF 11-16-2021

"THIS TAX MAP PLATE HAS BEEN DIGITALLY DRAWN USING COMPUTER-AIDED DRAFTING/DESIGN (CADD) AND COORDINATE GEOMETRY (COGO). IT IS BASED ON THE ORIGINAL DIGITALLY DRAWN TAX MAP PLATE BEARING THE OFFICIAL NEW JERSEY DIVISION OF TAXATION APPROVAL STAMP WITH APPROVAL DATE (7-31-2006) SERIAL NUMBER (896) AND SIGNATURES OF SIGNERS' JAMES J. COLL, CHIEF, LOCAL ASSESSMENT, SANTO C. DIDONATO, SUPERVISING FIELD REPRESENTATIVE. THE ORIGINAL DIGITALLY DRAWN TAX MAP PLATE WITH THE OFFICIAL APPROVAL STAMP IS ON FILE WITH THE TOWNSHIP OF BARNEGAT ENGINEER."

KEY MAP 3